

Recommended hole size of mounting plate

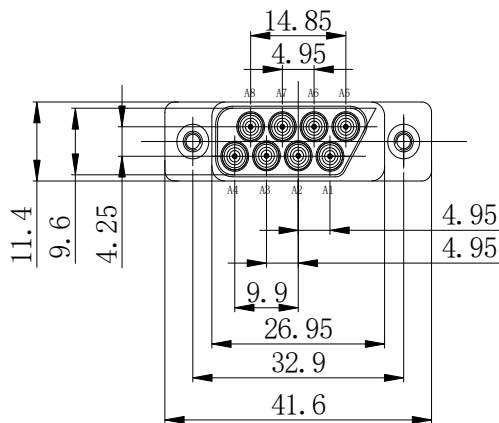
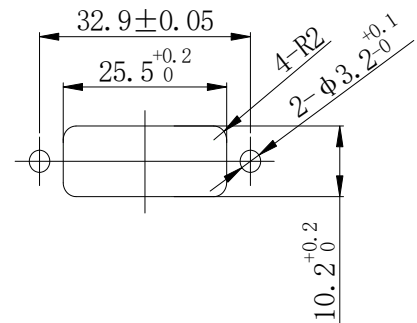

\* Label and Shrinking tube design depend on customer's request.

## Configuration

Connector 1 Type	GH-ZGJ8SNI01
Connector 1 Body Style	Straight
Body Material and Plating	Black anodizing of aluminum
Connector 1 Mount Method	Installation of flange through wall (installation in front of plate)
Connector 1 Docking End Model	GH-TGK8SNI01
Connector 2 Type	SMA Male
Connector 2 Body Style	Straight
Body Material and Plating	Brass Gold Plated
Connector 2 Mount Method	None
Cable Type	3506 Series

## Electrical Specifications

Impedance	50 $\Omega$
Frequency	DC to 18GHz
Return Loss/VSWR	1.35 to 18GHz
Shielding Effectiveness	<-100dB @ 1GHz
Power Handling	90watt @ 4GHz at sea level,VSWR1.0

## Environmental Data

Temperature Range	-40°C to +125°C
2002/95/EC(RoHS)	Compliant

## Cable Specifications

Center Conductor	Silver plated copper
Dielectric	e PTFE
Jacket	FEP
Capacitance(pF/m)	94
Velocity of propagation(%)	82
Min. bending radius(mm)	6
Jacket Diameter(mm)	2.2

**Part Number List**

Part Number	Length [mm]	Insertion Loss $\leq$ (dB)
GAM8U2-YATFSMMM-3000	3000 $\pm$ 30	9.77@18GHz
GAM8U2-YATFSMMM-2500	2500 $\pm$ 20	8.25@18GHz
GAM8U2-YATFSMMM-2000	2000 $\pm$ 20	6.73@18GHz
GAM8U2-YATFSMMM-1500	1500 $\pm$ 15	5.21@18GHz
GAM8U2-YATFSMMM-1000	1000 $\pm$ 10	3.69@18GHz
GAM8U2-YATFSMMM-500	500 $\pm$ 10	2.17@18GHz

While the information has been carefully compiled to the best of our knowledge, nothing is intended as representation or warranty or our part and no statement herein shall be construed as recommendation to infringe existing patents. In the effort to improve our products, we reserve the right to make changes judged to be necessary.